

# Quick Start Guide

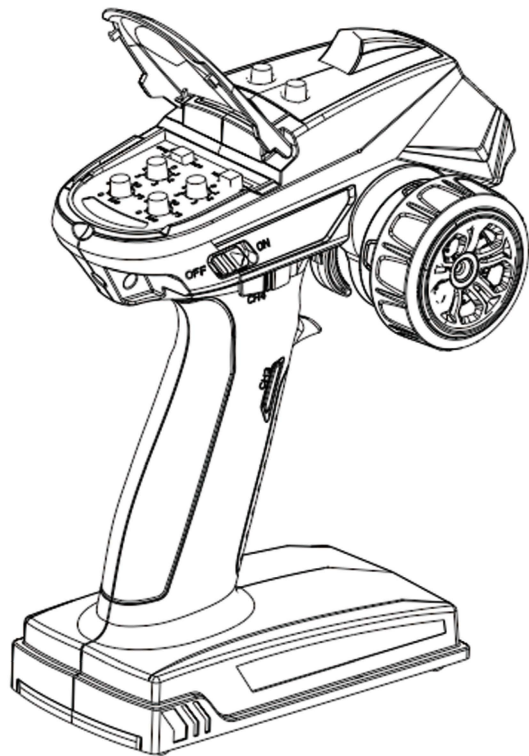

## Features:

- 2.4G technology, FHSS 67 channels frequency-hopping spread spectrum, highly resistant to anti-jamming.
- Receiver response time is 3ms, ensuring a fast response and better control.
- Smooth and highly sensitive to control inputs and stable at distances from 400-500m.
- Compatible with a variety of vehicles; suitable for RC cars, RC boats and RC tanks.
- With brake and fail safe, out of control protection function.
- Each of the 3 channels can be set respectively, supporting mixed control of 1 and 2 channels.
- Voltage range of the transmitter: 4.8V-12V(support 1s-3s), automatic identification of voltage, low voltage warning: 7.4V/4.8V
- Voltage range of the receiver: 3.3V-10V, working current 30mA, supports high voltage servos.
- The unique throttle speed limit adjustment function, allows beginners to practice at a safe speed.

## Channel function

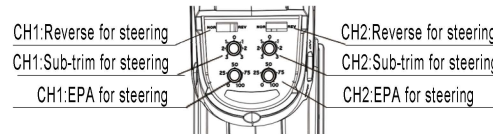
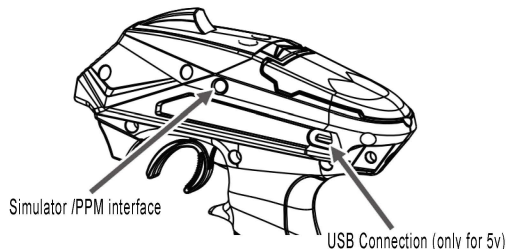
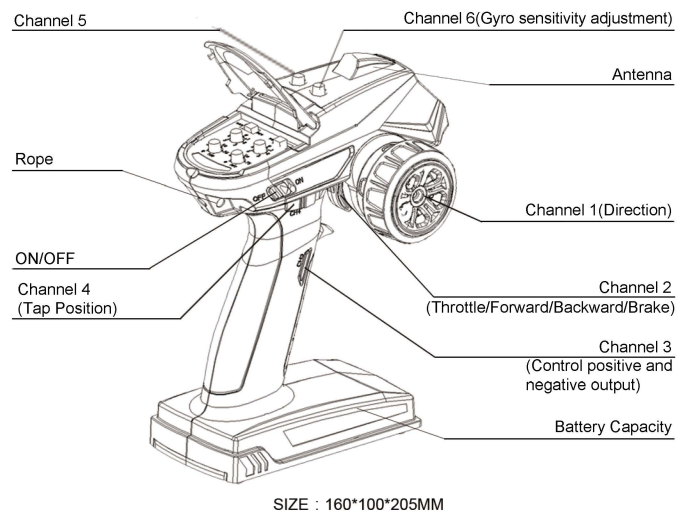

## Basic operation

### > Battery installation:

- Open the battery compartment cover.
- Insert 4 AA fully charged batteries or 2S Li-Po batteries with correct polarity. (No response if battery polarity reversed).
- Replace battery compartment cover.

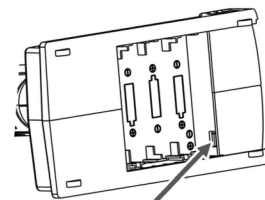

The battery socket is equipped with anti-reverse insertion function, wrong polarity connection will not burn the transmitter.

### >Binding process:

- Press receiver button, LED indicator fast flashing means entering into binding mode, the receiver will automatically start looking for the nearest transmitter signal.
- The indicator will always be ON after successful binding.

- Receiver response time is 3ms, ensuring a fast response and better control.
- Voltage range of the receiver: 3.3V-10V, working current 30mA, supports high voltage servos.

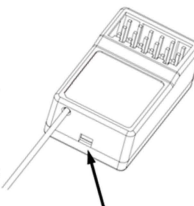

### > LED lights:

Direction control mode for servo normal steering: Blue light is always on.  
 Mixed direction control mode for tank: Red light is always on.  
 Low voltage warning: Yellow light flashes slowly.  
 Enter into the second level menu setting mode: Blue/Red light fast flashing.

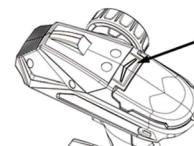

### > Radio control accessory

Phone bracket and transmitter hand carry set are available

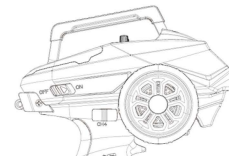

## Menu Settings

### > Enter into program mode

Move the steering wheel to the max forward position, then power the transmitter, release the steering wheel and press the 3rd channel button. The panel LED indicator will flash quickly indicating that you have entered settings mode.

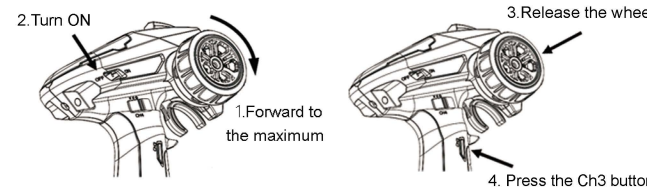

The route of the forward and backward rotation of the direction wheel indicates the setting of the route of the servo. The route of the forward and backward of the throttle trigger indicates the forward and backward route. After the route sets well, the trigger and the steering wheel return to the middle position. If it is not necessary to set the 3rd-channel and 4th-channel route, press the 3rd-channel button to confirm the setting after the steering wheel and trigger are still at the mid-point for 3 seconds. After the setting is successful, the indicator light will stay on and enter the normal mode. (Default factory setting are maximum route for the 1st channel and 2nd channel)

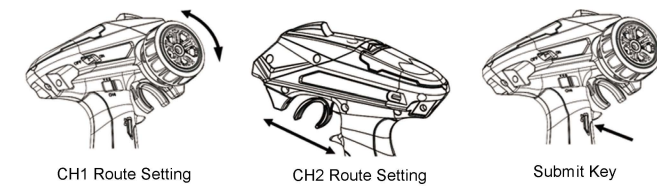

1. In the setting mode, 1st and 2nd use the channel adjustment knob on the panel to set the 3rd channel and 4th channel route.  
 2. Namely after entering the secondary menu: the item will be the default 1st and 2nd channel route of the adjust rotational position confirmed 3rd and 4th Channel route; It can be manually adjusted with the size of the knob numerical;  
 3. Change 3rd and 4th channel route, press the three channels to confirm the Settings. (the Factory default maximum route: the 1 Channel knob to adjust the 3 Channel route, the 2 Channel knob to adjust the 4-channel route).  
 Caution: 1. After entering the Secondary menu, the system will automatically remove Channel 1 and Channel 2, the previous value of unilateral route memory, and must reset a unilateral route volume, otherwise the system defaults to 0. 2. After entering normal usage mode, the location of the Channel 1 and Channel 2 route represent the new Channel 1 and Channel 2; it can readjust the channel 1 and channel 2 route in usage mode.

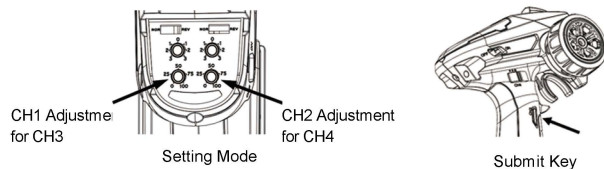

## Mode switch:

Pull throttle trigger to the max, then power on the transmitter. After the LED indicator flashes quickly, release the trigger. The indicator LED will change colors, release the throttle trigger to the neutral position. The indicator light will stay solid, indicating that the mode is successfully switched. (Normal mode blue light is always on, mixing mode red light is always on)

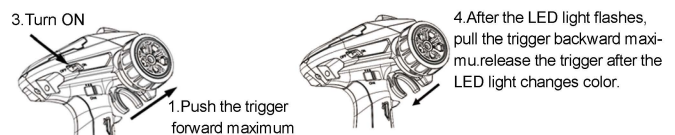

## Mixed mode:

Connect the two ESC signal lines to the channel 1 and channel 2 of the receiver. under the mixed mode, the trigger moves backward and forward to control the rotation of the two motors. The positive and negative rotation of the motor can be set through the two positive and negative switches on the control panel.

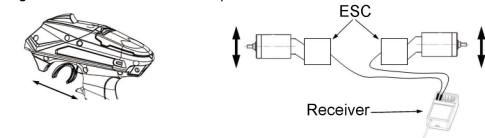

In the mixed mode, the RC model moves forward at a certain speed. At this time, the speed of the two motors can be adjusted by channel 1 directional wheel to realize differential steering.

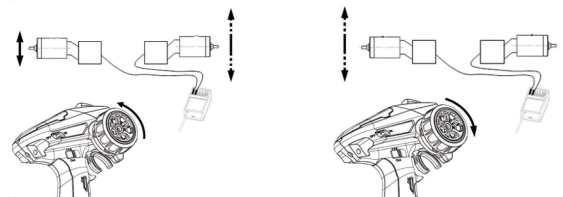

In the mixed control mode, the channel 1 and channel 2 pass forward and reverse direction, neutral point and motor route can be set separately.

## Digital Proportional Radio Control System





# 快速操作指南

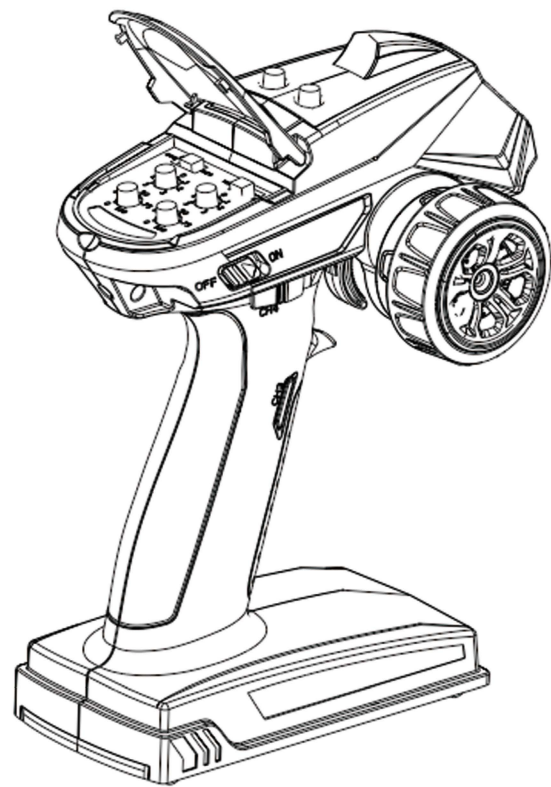

东莞市质顶模型有限公司

## 特点功能

- > 2.4G扩频技术, FHSS 67信道伪随机跳频, 超强抗干扰。
- > 接收机3ms极速响应, 全数字化不失控不死机。
- > 操控灵敏顺畅, 稳定距离400-500米。
- > 高性价比, 适合车、船、坦克用。
- > 带刹车, 失控保护功能。
- > 3个通道分别可任意设置单边行程量, 支持1、2通道混控。
- > 遥控器电压范围: 4.8V-12V (支持1S-3S), 自动识别电压, 低压报警 7.4V | 4.8V。
- > 接收机电压范围: 3.3V-10V, 工作电流30mA, 支持高压舵机。
- > 独特的油门限速调节功能, 让初学者在安全的速度下快速入门练习。

## 产品通道描述

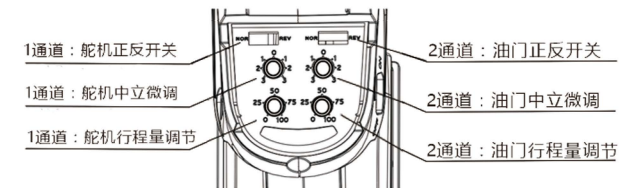
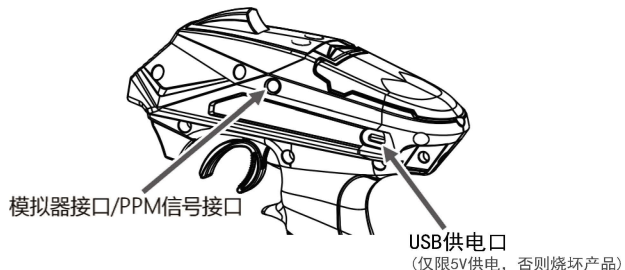
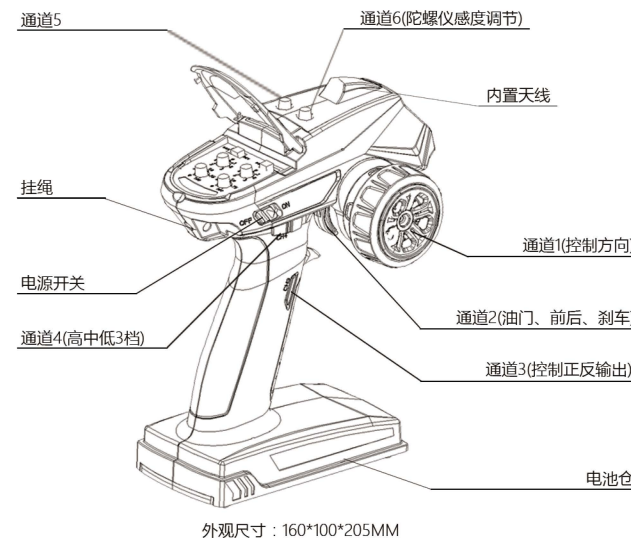

## 基本操作

- ### > 电池安装
1. 打开电池舱盖;
  2. 将4个电量充足的5号AA电池或者2S锂电池装入电池仓内, 确保电池上的金属端子与电池仓内的金属端子相接;
  3. 盖好电池舱盖。
- 
- 电池插口自带防反插功能, 正负极接反不会烧毁本产品

- ### > 接收机
- 接收机3ms极速响应, 全数字化不失控不死机。  
电压范围: 3.3V-10V, 工作电流30mA, 支持高压舵机。
- ### > 对码
- 接收机对码, 按一秒指示灯快闪表示进入对码模式, 接收机自动寻找最近的遥控器信号, 对码成功后指示灯常亮。
- 

- ### > LED灯
- 车用普通舵机控制方向模式蓝色灯常亮, 混控坦克模式控制方向红色灯常亮, 低压报警黄色灯慢闪, 进入二级菜单设置模式指示灯快闪
- 

- ### > 遥控器扩展
- 可拓展FPV车手机支架及遥控器提手。
- 

## 菜单设置

- ### > 进入设置
- 一、手轮向前打到最大, 按住第三通道按键同时开机, 3秒后先松开3通安健, 再松手手轮, 面板指示灯会快闪, 表示进入设置模式。

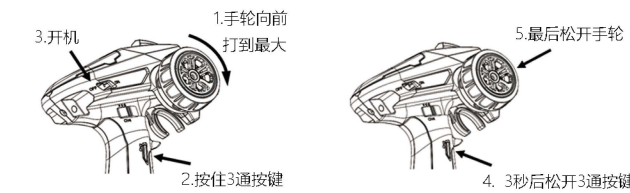

二、方向手轮向前后转动的大小行程表示单边舵机行程量设置, 油门扣机向前后扣动的大小行程表示前进后退单边行程量设置, 行程设置好后扣机和手轮回到中点位置, 如不需要继续设置3通和4通行程量, 可在手轮和扣机在中点位置静止3秒后按下3通道按键确认设置, 设置成功后面板指示灯会常亮, 进入正常使用模式。(出厂默认1通、2通最大行程量)



三、在设置模式下, 面板上面的1通、2通的行程量调节旋钮用来设置3通和4通的行程量, 即进入二级菜单后, 产品会默认1通和2通的行程量调节旋钮停留位置确认为3通和4通的行程量, 可以用手动调节旋钮数值的大小, 改变3通和4通的行程量, 按下3通道确认设置。(出厂默认最大行程量, 1通旋钮调节3通行程量, 2通旋钮调节4通行程量)。注意: 进入二级菜单后系统会自动清除1通和2通之前单边行程量的数值, 必须重新设置一次单边行程量, 否则系统默认为0。进入正常使用模式后, 1、2通行程量旋钮停留的位置代表新的1、2通总行程量, 可在设置模式下重新调节1、2通行程。

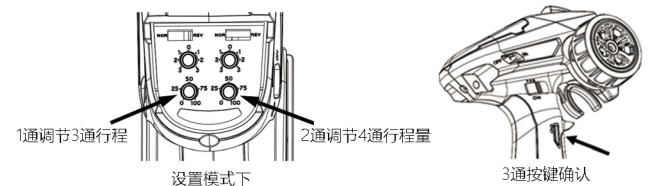

## 模式切换

油门扣机向前推到最大按住3通道按键开机, 指示灯快闪后把油门扣机向后勾到最后, 指示灯颜色变化后扣机回到中间位置, 松开3通道开关, 指示灯常亮表示模式切换成功(普通模式蓝色灯常亮, 混控模式红色灯常亮)



## 混控模式

将两个电调的信号线分别接入接收机的一、二通通道上, 在混控模式下, 扣机前后扣动控制2个电机同时前、后转动, 可通过控制面板上的2个正反开关设置电机的正反转。

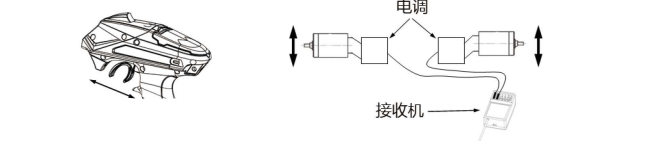

在混控模式下, 模型按一定的速度往前行驶, 这时候转动1通方向手轮, 可以调节两个电机的转速, 实现差速转向。

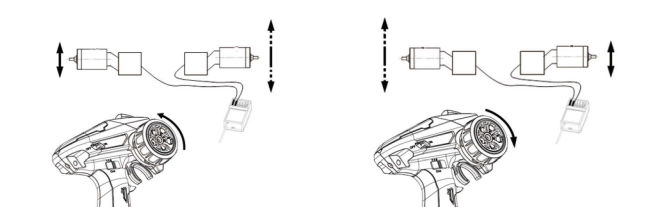

在混控模式下, 面板上的1、2通正反向、中立点及电机行程量的设置和普通模式下的一样, 均可单独设置。

## 数字比例无线电遥控器